

199 WATER STREET

SEAPORT DISTRICT

Entire 9th Floor | Test-Fit | 35,454 SF

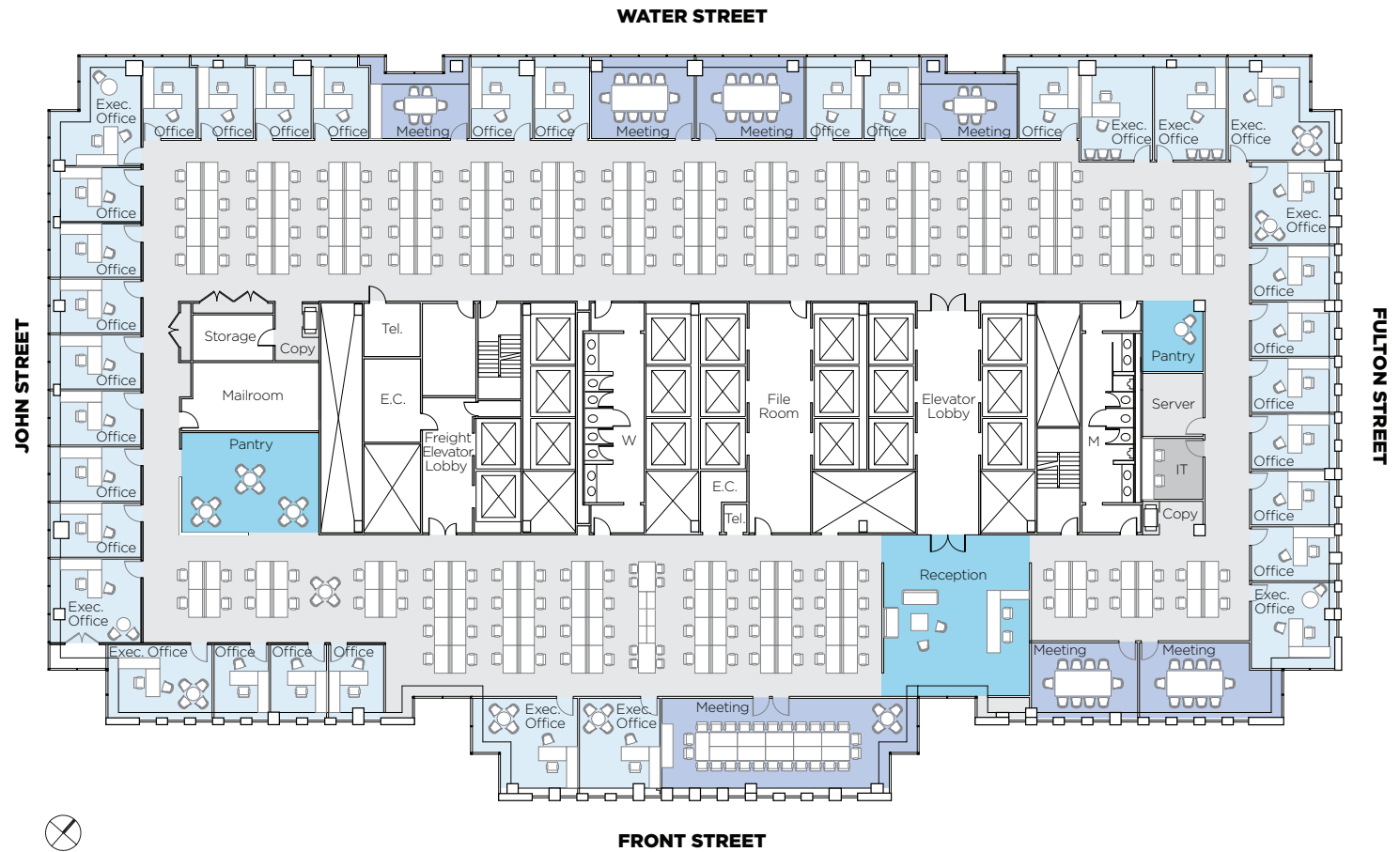

WORK PLACE		People
Private Office		51
Workstation		55
Total		106

MEET		
	Rooms	Seats
Board Room	1	18
Conference Room	4	38
Phone Room	6	6
Total	11	62

SOCIAL		
	Area	Seats
Reception	1	6
Café / Pantry	1	29
Huddle	3	24
Total	5	59

Total Dedicated Desks 106 People

**Total Collaborative Seats
Open & Enclosed 121 Seats**

Jack Resnick & Sons
Owners & Builders Since 1928

110 East 59 Street
New York, NY 10022-1379
resnicknyc.com

Adam S. Rappaport
646.253.3111
arappaport@resnicknyc.com

Brett S. Greenberg
646.253.3113
bgreenberg@resnicknyc.com



No warranty or representation, express or implied, is made as to the accuracy of the information contained herein, and same is submitted subject to errors, omissions, change of price, rental other conditions, withdrawal without notice, and to any special listing conditions, imposed by our principals.

PARTIAL FLOOR 9 PROPOSED PREBUILT SUITE 1 - 16,719 RSF

WORK PLACE		People
Private Office		8
Workstation		68
Total		76

MEET		Rooms	Seats
Conference Room		10	61
Phone Room		5	8
Total		15	69

SOCIAL		Area	Seats
Reception		1	7
Pantry		1	32
Total		2	39

Total Dedicated Desks **76 People**

**Total Collaborative Seats
Open & Enclosed** **108 Seats**

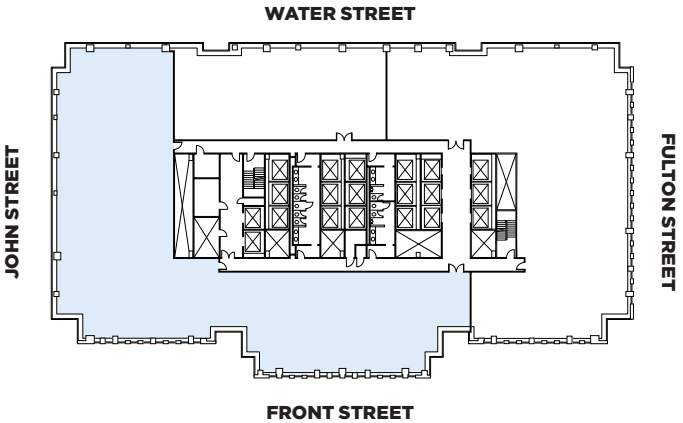

PARTIAL FLOOR 9 PROPOSED PREBUILT SUITE 2 - 13,299 RSF

WORK PLACE		People
Private Office	5	
Workstation	79	
Total	84	

MEET		Rooms	Seats
Conference Room	5	40	

SOCIAL		Area	Seats
Reception	1	3	
Pantry	1	4	
Total	2	7	

Total Dedicated Desks 84 People

**Total Collaborative Seats
Open & Enclosed 47 Seats**

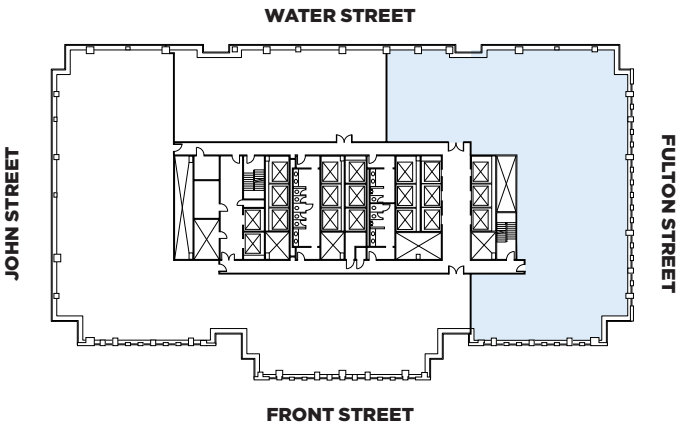

PARTIAL FLOOR 9 PROPOSED PREBUILT SUITE 3 - 5,436 RSF

WORK PLACE		People
Private Office	3	3
Workstation	21	21
Total	24	24

MEET		Rooms	Seats
Conference Room	2	14	
Phone Room	1	1	
Total	3	15	

SOCIAL		Area	Seats
Reception	1	7	
Pantry	1	7	
Total	2	7	

Total Dedicated Desks **24 People**

**Total Collaborative Seats
Open & Enclosed** **22 Seats**

