

## Partial 17th Floor | Test-Fit | 5,743 SF

**LEGEND**

WORKSPACE	SEATS
PRIVATE OFFICE	4
BENCHING (6'X30")	24
RECEPTION	1
<b>TOTAL HEADCOUNT</b>	<b>29</b>

COLLABORATIVE SPACE	
CONFERENCE ROOM	1
OPEN LOUNGE	1

SUPPORT	
PANTRY	1
COAT CLOSET	1
COPY AREA	1
STORAGE ROOM	1
IT/STORAGE ROOM	1

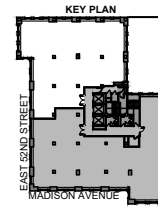

485 MADISON AVENUE

PREBUILD TEST FIT B

17TH FLOOR - EAST

05.04.22

**Jack Resnick & Sons**  
Owners & Builders Since 1928

110 East 59 Street  
New York, NY 10022-1379  
resnicknyc.com

**Adam Rappaport**  
646.253.3111  
arappaport@resnicknyc.com

**Brett S. Greenberg**  
646.253.3113  
bgreenberg@resnicknyc.com



No warranty or representation, express or implied, is made as to the accuracy of the information contained herein, and same is submitted subject to errors, omissions, change of price, rental other conditions, withdrawal without notice, and to any special listing conditions, imposed by our principals.