

170 WEST 23 STREET

CHELSEA

Partial Ground Retail | As-Built | 1,700 SF

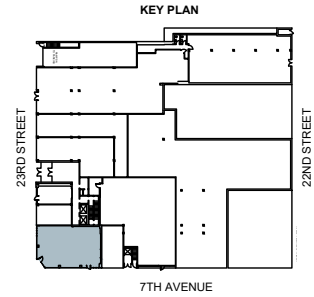
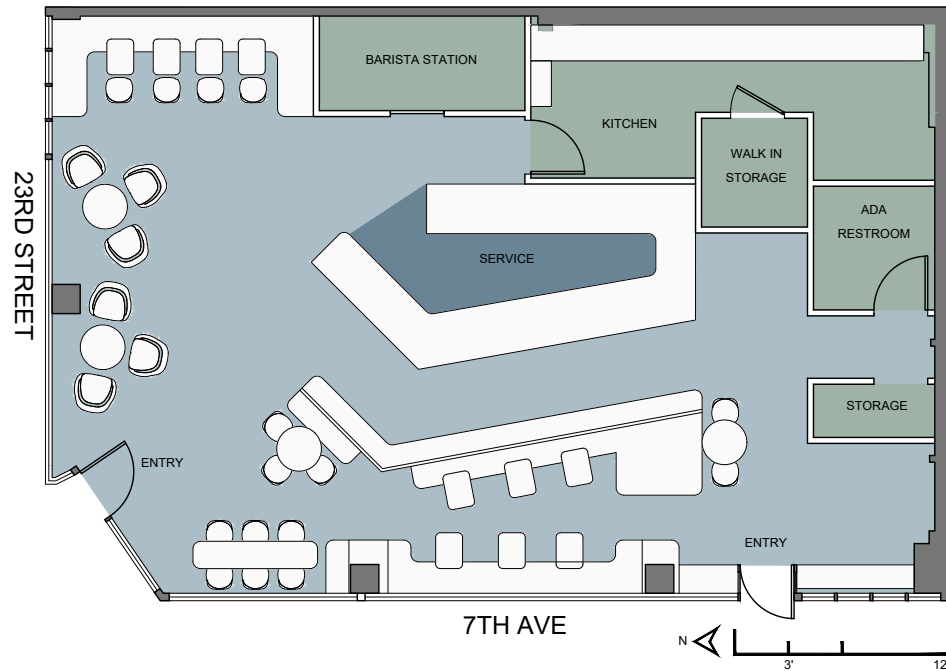

170 WEST 23RD STREET

GROUND FLOOR RETAIL

AS BUILT PLAN

07.02.24

 Jack Resnick & Sons  
Owners & Builders Since 1928

110 East 59 Street  
New York, NY 10022-1379  
resnicknyc.com

**Fran Delgorio**  
646.253.3100  
fdelgorio@resnicknyc.com

**Brett S. Greenberg**  
646.253.3113  
bgreenberg@resnicknyc.com

No warranty or representation, express or implied, is made as to the accuracy of the information contained herein, and same is submitted subject to errors, omissions, change of price, rental other conditions, withdrawal without notice, and to any special listing conditions, imposed by our principals.