

# Floor Plan

200 Chambers  
Street  
*Tribeca*

## Ground Floor Retail Space

- ▶ 43' FRONTAGE ON CHAMBERS STREET
- ▶ 19' CEILING HEIGHTS
- ▶ FULL-HEIGHT SIGNAGE OPPORTUNITY
- ▶ LONG-TERM LEASE AVAILABLE
- ▶ NEIGHBORS INCLUDE WHOLE FOODS, TARGET AND HOBBY LOBBY

*Chambers Street*

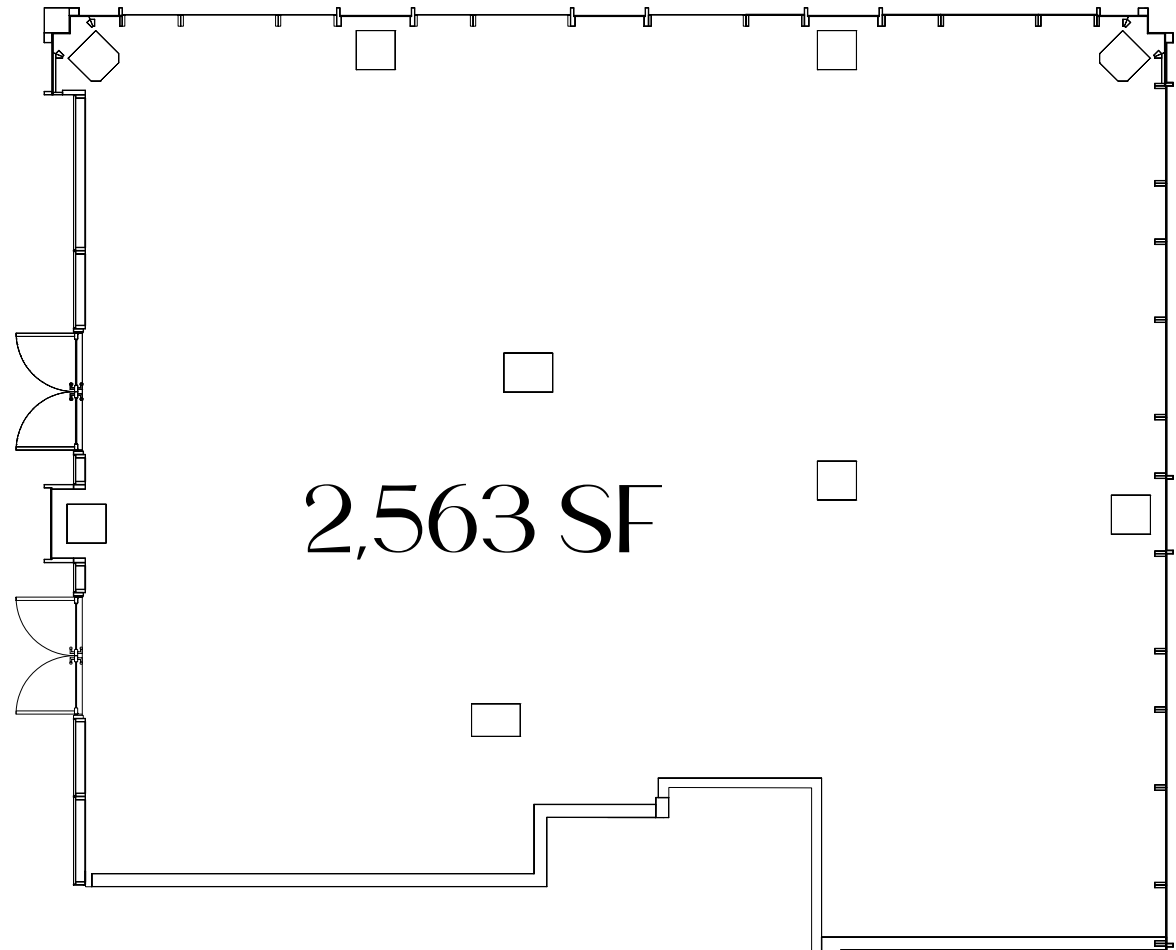

*For Leasing Information  
Please Contact*

BRETT S. GREENBERG  
646.253.3113  
BGREENBERG@RESNICKNYC.COM

FRAN DELGORIO  
646.253.3100  
FDELGORIO@RESNICKNYC.COM



Jack Resnick & Sons  
*Owners & Builders Since 1928*