

Floor Plan

200 Chambers Street
Tribeca

Ground Floor Retail Space

- ▶ 43' FRONTAGE ON CHAMBERS STREET
- ▶ 19' CEILING HEIGHTS
- ▶ FULL-HEIGHT SIGNAGE OPPORTUNITY
- ▶ LONG-TERM LEASE AVAILABLE
- ▶ NEIGHBORS INCLUDE WHOLE FOODS, TARGET AND HOBBY LOBBY

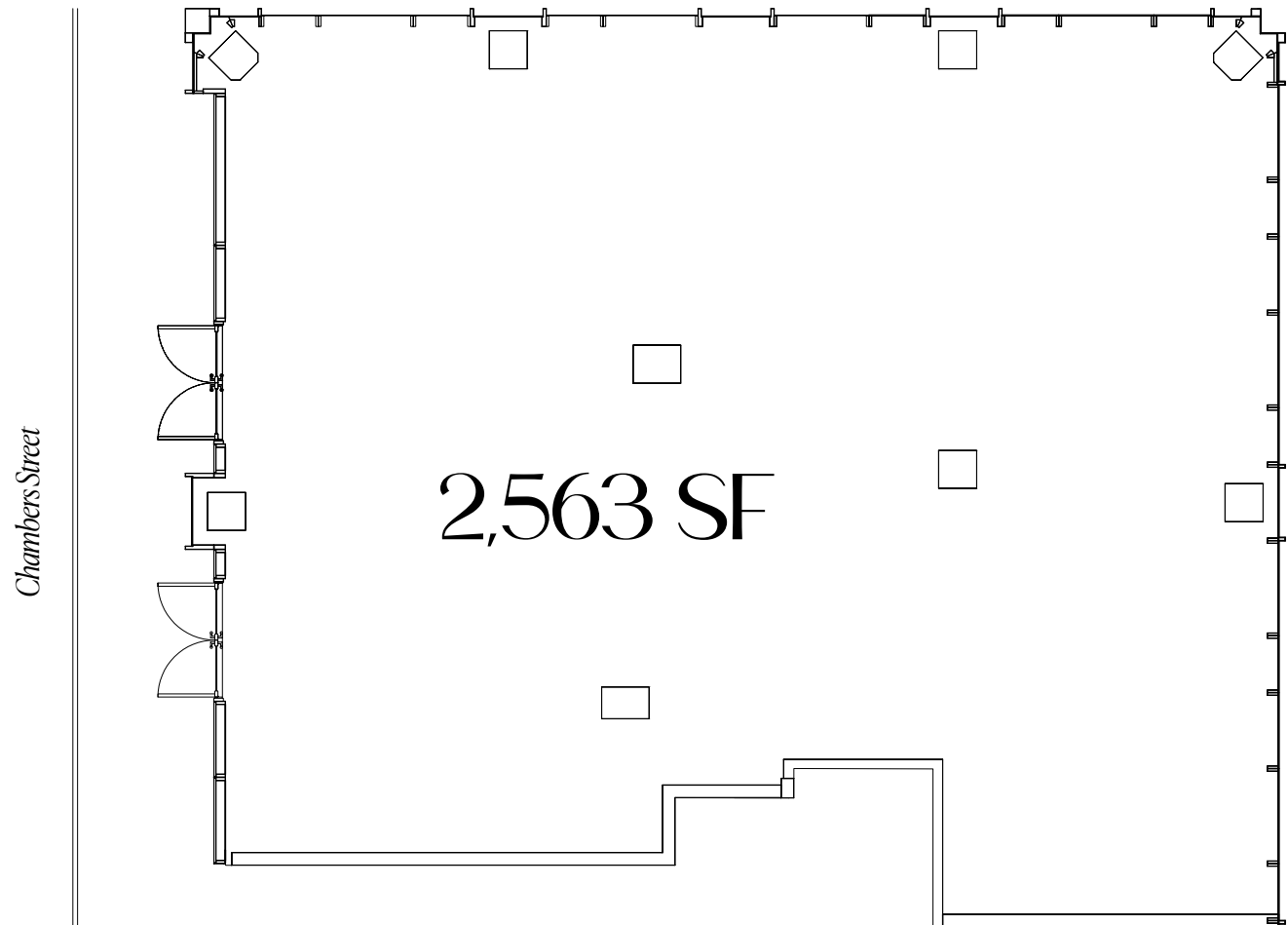

*For Leasing Information
Please Contact*

BRETT S. GREENBERG
646.253.3113
BGREENBERG@RESNICKNYC.COM

 Jack Resnick & Sons
Owners & Builders Since 1928